

PRODUCTION *house*



*Studio
Specs*

STUDIO RATES

DAILY & HOURLY

\$100 per hour with a 2 hr minimum to book

- CYCLORAMA INCLUDED
- BASIC GEAR INCLUDED
- UP TO 10 PEOPLE
- ADDITIONAL \$10 FEE PER PERSON OVER THE 10 PERSON LIMIT, UP TO A TOTAL OF 30 PEOPLE

MEMBERSHIPS

COMING SOON!

EVENTS

\$200 per hour starting for parties of 30 people and minimum of 9 hours

- MAX 75 PEOPLE
- EVENT & DECOR DESIGN
- DAY OF SUPPORT & COORDINATION

ENTRANCE

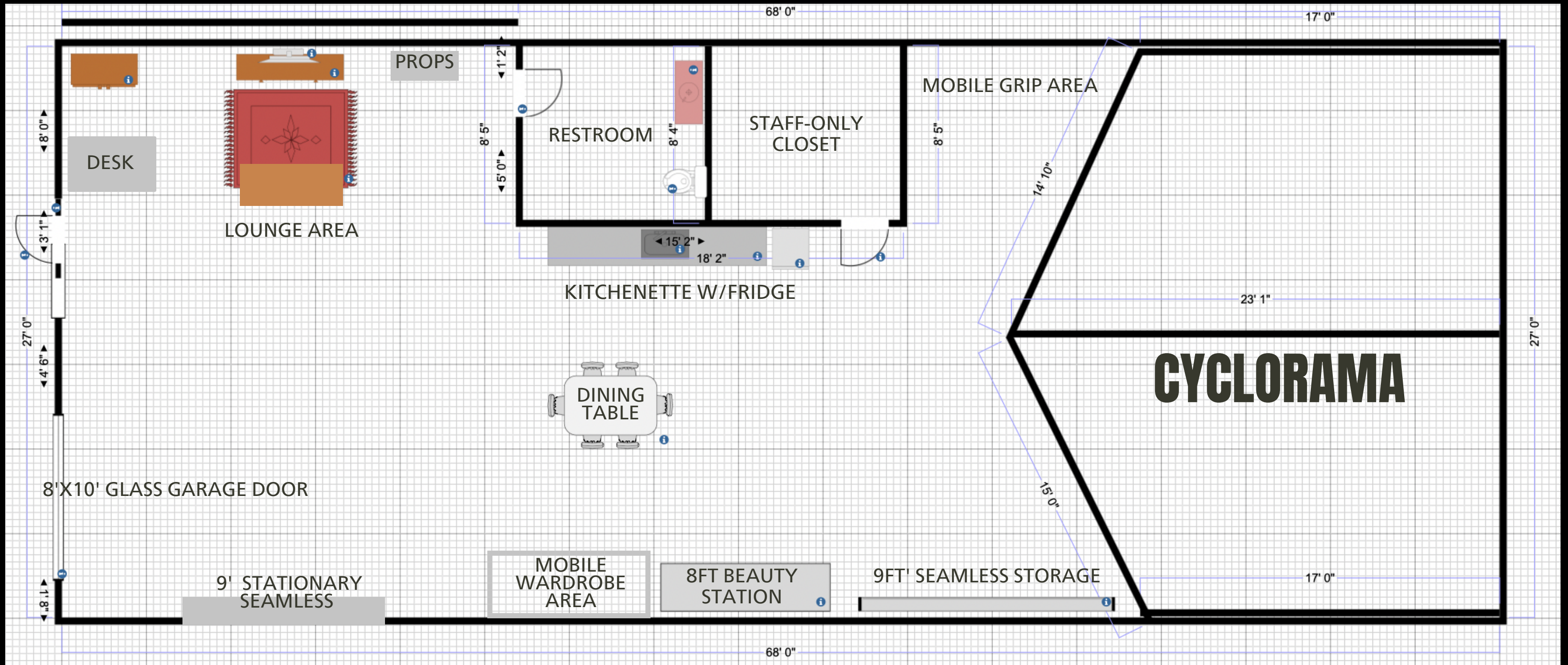

STUDIO LAYOUT

Our studio layout is designed to optimize creativity and convenience, featuring a spacious 27'x17' 3-sided cyclorama and versatile natural light areas. With comfortable amenities, flexible workspaces, and professional equipment, it's the perfect space to bring your vision to life.

STUDIO AMENITIES

Welcome to a Studio Where Every Detail Speaks Volumes

A LARGE AND BEAUTIFUL 2100 SQ FT SPACE, WITH A LAYOUT AS VERSATILE AS YOUR IMAGINATION, INCLUDING OUR CYCLORAMA WALL

EFFORTLESS BOOKING WITH OUR STREAMLINED AND USER-FRIENDLY SYSTEM

EXTENSIVE SELECTION OF RENTAL GEAR AVAILABLE TO BRING YOUR VISION TO LIFE WITH EASE.

HIGH-SPEED & RELIABLE WIFI CONNECTIVITY

SPACIOUS HAIR & MAKEUP STATION FOR CONVENIENCE AND COMFORT

PRIVATE BATHROOM AND CHANGING ROOM

CONVENIENT KITCHENETTE, INCLUDES A FRIDGE AND AMENITIES FOR YOUR REFRESHMENT NEEDS

COMFORTABLE ASSORTMENT OF CHAIRS AND STOOLS AVAILABLE FOR YOU & AND YOUR CLIENTS

ACCESS TO A DIVERSE SELECTION OF PROPS TO ENHANCE YOUR SET DESIGN

DEDICATED NATURAL LIGHT AREA WITH AN 8'X10' EAST-FACING GLASS paneled GARAGE DOOR

SHEER CHIFFON, WHITE & BLUSH-COLORED VELVET CURTAINS FOR VERSATILE LIGHT CONTROL

65" SAMSUNG FRAME TV FOR VIDEO VILLAGE SETUP OR IMAGE REVIEW. AS WELL AS BLUETOOTH SPEAKER

COMFORTABLE LOUNGE AREA WITH SOFA & ASSORTED AREA RUGS CREATE A COZY ATMOSPHERE

FLEXIBLE OPEN CONCEPT WORKSPACE WITH HEAVY-DUTY ROLLING WORK TABLES FOR EASY CUSTOMIZATION

PROFESSIONAL STEAMER TO ENSURE YOUR WARDROBE LOOKS PRISTINE

UPON REQUEST, ADDITIONAL TABLES AND CHAIRS CAN BE PROVIDED TO MEET YOUR SPECIFIC NEEDS



BASIC PHOTO + VIDEO GRIP GEAR INCLUDED

Our studio includes a variety of basic grip gear to help you create professional-grade images and videos. Essential items such as light and backdrop stands, sandbags, clamps, and more are readily available.

Additionally, you'll find a range of mounting options, including C-stands, magic arms, and suction cups, allowing you to securely mount lights, cameras, and other equipment in various positions.

The inclusion of basic photo and video grip gear with your rental ensures you feel supported in creating high-quality content without the need to bring all your own equipment, saving you time and money while enabling you to focus on the creative aspects of your shoot.





INCLUDED GEAR

8 STANDARD C-STANDS

20 SANDBAGS

1 LEVEL OF SCAFFOLDING

STANDING MIRROR

4 EXTRA TALL C-STANDS

TWO REVERSIBLE 8 FOOT TALL
V-FLATS

ASSORTED ATTACHMENTS FOR
C-STANDS

VORNADO DIRECTIONAL FAN

ASSORTED EXTENSION CORDS

MAKEUP+HAIR STATION W/
HOLLYWOOD MIRROR

MULTITUDE OF CLAMPS

ASSORTED WHITE AND BLACK
CARDS

2 NESTING APPLE BOXES/
2 STANDARD APPLE BOXES

GARMENT RACK WITH HANGERS
AVAILABLE

LARGE ASSORTMENT OF PLANTS -
WE MEAN A LOT OF PLANTS

PROP LIBRARY

2 ROLLING PHOTO TABLES

ASSORTMENT OF LINENS

RENTABLE GEAR

1 Set Reflector Grid Kit - 10/15/20
Degrees

1 Projector

3 Profoto D2 (500W AC Strobes)

3 Profoto D2 (500W AC Strobes)

1 Manfrotto
Tripod

3 Rectangle Blocks

1 Nikon / 1 Canon / 1 Sony
Profoto AirTTL Remote

3 Profoto 8" Zoom Reflectors

1 Profoto Rfi 2x3 Softbox
Rectangle

3 Cubed Blocks

1 Profoto Scrim Jim Cine Full Stop
Silk

1 White Large Umbrella

1 Westcott Beauty Dish for
Profoto

King Air Mattress

1 Profoto Rfi 5' Octa Softbox

1 White Deep Umbrella

2 Small Tripods



THANK YOU

CONTACT
US

EMAIL
BOOK@PRODUCTIONHOUSEDALLAS.COM

MOBILE
972.978.1789

MAILING ADDRESS
4731 MEMPHIS ST, DALLAS TX 75207

